

SUBMITTAL TO THE BOARD OF SUPERVISORS  
COUNTY OF RIVERSIDE, STATE OF CALIFORNIA

901 B



FROM: TLMA – Transportation Dept.

SUBMITTAL DATE: March 10, 2003

SUBJECT: TRACT 25219-2

A Schedule "B" Subdivision in the Woodcrest Area

**EXTENSION OF TIME AGREEMENTS/NEW OWNER/BOND  
REDUCTION/SUBSTITUTION OF SECURITIES**

**RECOMMENDED MOTION:** That the Board approve the attached agreements (which grant an extension of time for twelve months to complete improvements) and approve and accept the substitution of securities as approved by County Counsel.

**BACKGROUND:** On January 25, 2000, the Board entered into agreements with TNR Development Corporation for the improvement of streets, the installation of a water system, and the setting of lot corners and subdivision monuments within the above referenced subdivision. Accompanying these agreements were securities posted by Frontier Pacific Insurance Company as follows:

- \$712,500 - Bond SD00080406 for the completion of street improvements
- \$130,500 - Bond SD00080406 for the completion of the water system
- \$421,500 - Bond SD00080406 for the material and labor security
- \$14,500 - Bond SD00080407 for the monumentation security

(Continued)

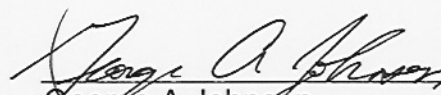
  
 \_\_\_\_\_  
 George A. Johnson  
 Director of Transportation

HS:lf  
 Submittals: Vicinity Map  
                   Road/Drainage Improvement Agrmts  
                   Water System Maintenance Agrmts  
                   Survey Monument Agreements

Policy  
 Policy

Consent  
 Consent

Department Recommendation:  
 Per Executive Office:

Prev. Agn. Ref. 01/25/00 - 2.10

Dist. 1

AGENDA NO.

2.8

REVIEWED BY EXECUTIVE OFFICE  
 DATE 3/11/03  

The Honorable Board of Supervisors

RE: Tract 25219-2

March 10, 2003

Page 2 of 2

The Crest at Hawarden, LLC is the new owner of the property and wishes to substitute new securities for this project. The bond amounts have been recalculated to reflect current construction costs and are now posted as follows, by Gulf Insurance Company:

\$712,500 - Bond B34229703 for the completion of street improvements

\$130,500 - Bond B34229703 for the completion of the water system

\$421,500 - Bond B34229703 for the material and labor security

\$14,500 - Bond B34229704 for the monumentation security

The developer requests an extension of time for the completion of Tract 25219-2. Our records indicate that this project is approximately 50% completed for streets and 70% completed for utility work. The agreements and new securities for the extension of time have been approved by County Counsel.

LEFT		EXISTING BUILDING
RIGHT		FIRE HYDRANT
CENTERLINE		EXISTING CONCRETE
Y EASTERLY, WESTERLY		EX. ST. LIGHT
Y SOUTHERLY, NORTHERLY		EX. SIDEWALK
TOP OF CURB		EX. WATER METER
FLOW LINE		EX. WATER VALVE
EDGE OF PAVEMENT		EX. MAN HOLE
PORTLAND CEMENT CONCRETE		PROP. CHAINLINK FENCE
CATCH BASIN		PROP. BLOCK WALL
PROP. STREET TREE		DIRECTION OF FLOW
BEGIN EDGE PAVEMENT RETURN		
END EDGE PAVEMENT RETURN		
EDGE PAVEMENT RETURN		
ON TANGENT		
VERTICAL CURVE		
POINT OF INTERSECTION		
PROP. STREET LIGHTS		

16. ONLY LANDSCAPING CONSIDERED TO BE INSTALLED WITHIN PARKWAYS (OR OTHER AREAS), AND ALL LANDSCAPING SHALL BE SEPARATE LANDSCAPE PLANS. ALL LANDSCAPING SHALL CONFORM TO RIVERSIDE COUNTY ADMINISTRATION OF LANDSCAPING REGULATIONS.

17. ANY PRIVATE DRAINAGE FACILITIES SHALL BE INFORMATION ONLY. BY SIGNING THESE PLANS, THE CONTRACTOR AGREES TO OBTAIN APPROVAL OF THOSE PRIVATE DRAINAGE FACILITIES FROM RIVERSIDE COUNTY TRANSPORTATION DEPARTMENT.

18. AFTER OCTOBER 1, 1992, ANY PROJECTS INVOLVING MORE THAN FIVE ACRES MUST OBTAIN A PERMIT TO DISCHARGE UNDER THE NATIONAL POLLUTION DISCHARGE ELIMINATION SYSTEM (NPDES) AND FILE A NOTICE OF INTENT TO DISCHARGE WITH THE CONTROL BOARD (SWRCB) AND DEVELOP A PREVENTION PLAN (SWPPP) APPROVED BY THE BOARD.

19. CONTRACTOR SHALL NOTIFY THE DISTRICT, OPERATIONS MAINTENANCE DIVISION, PRIOR TO ANY WORK IN METRO AREA.

## NOTICE TO CONTRACTOR

NOTE: NO STREET TREES WILL BE REMOVED OR PLANTED EXISTING OR FUTURE M.W.D. PROPERTY.

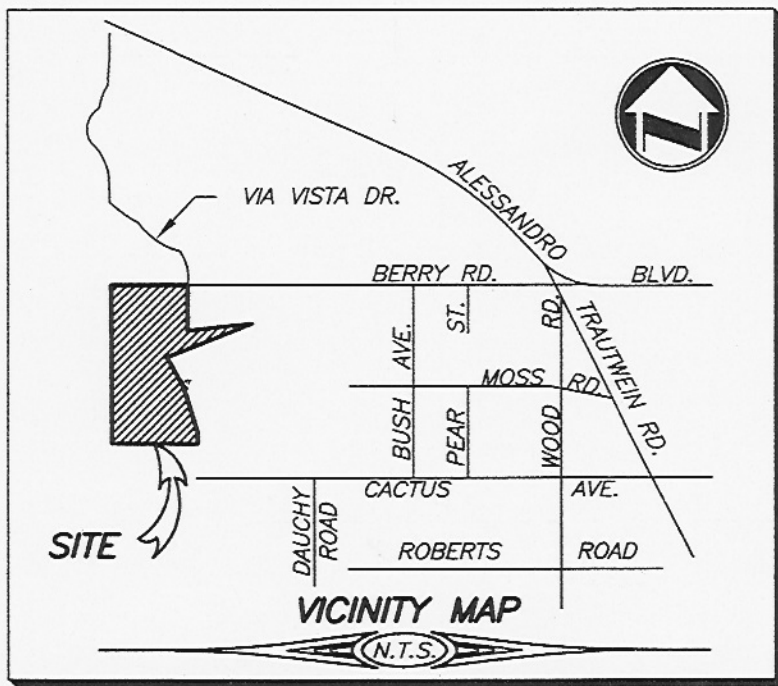

S.18, T.3 S., R.4 W.

## INDEX OF SHEET

SHEET No.(s)

1  
2-5  
6

**lkan**

BENCHMARK:

1 1/4" I.P., UP 0.5', WITH RIV. CO.  
SURVEY TAG MARKED "T3S-R4W S18S17 1/4"

TR  
C  
STREET IM